

TRUNNION
MATERIAL MILD STEEL

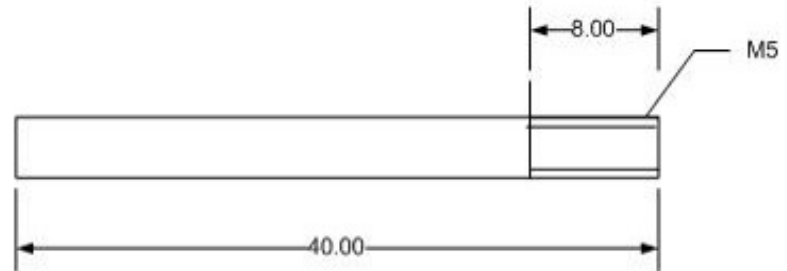

AXLE
MATERIAL 5mm DIA STEEL
AXLE TO BE SOLDERED INTO 5mm HOLE IN TRUNNION

Ø3.00
TO BE DRILLED AFTER
AXLE HAS BEEN SOLDERED IN

Ø5.00
COUNTERBORE 2MM DEEP

Ø3.00

STUB AXLE ASSEMBLY
(SHOWING LH VERSION -
RH SYMMETRICALLY
OPPOSITE)

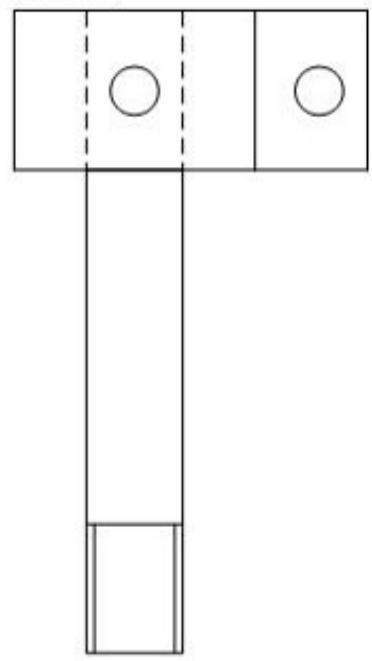

- NOTES**
- 1) CHAMFER ALL EXTERNAL EDGES 1MMx45 DEGREES
 - 2) GENERAL TOLERANCE ±0.5MM

REV	DESCRIPTION	BY	DATE
2	BRAZED CHANGED TO SOLDERED + COUNTERBORE ADDED	TC	8.6.05
1	ADD NOTES AND ASSY VIEW	TC	11.3.05
A	PROTOTYPE	TC	20.1.05

TITLE		
STUB AXLE ASSY		
MATERIAL	SEE DETAIL	
SCALE	2:1	
DRAWN BY	T.COX	20.1.05
CHECKED BY	A.NEEDHAM	DATE
APPROVED BY	A.NEEDHAM	DATE
PROJECT NUMBER	DRAWING NUMBER	
PEO LEVEL1 R/C CAR	CAR 2	